

TIMELESS
TREASURES

BROOME STREET PATTERNS



Christmas Joy

Arrowheads

Designed by Wendy Sheppard



Finished quilt size: 70½" x 70½"

Fabric Requirements

3⁵/₈ yards Dot-CM9528 Black

One CPSTRIP40-CM Christmas Joy 2¹/₂" strip set
(forty 2¹/₂" × width-of-fabric [WOF] strips)

4¹/₂ yards backing fabric of your choice

2/3 yard Holiday-CM1284 Red (binding)

79" × 79" batting

Cutting

From Dot-CM9528 Black:

- Cut sixteen 2¹/₂" × WOF strips. Sub-cut (252) 2¹/₂" squares.
- Cut one 4¹/₂" × WOF strip. Sub-cut twenty-six 1¹/₂" × 4¹/₂" strips.
- Cut two 5¹/₂" × WOF strips. Sub-cut twenty-six 1¹/₂" × 5¹/₂" strips from one strip; sub-cut ten 1¹/₂" × 5¹/₂" and ten 1¹/₂" × 4¹/₂" strips from the other strip.
- Cut one 7¹/₂" × WOF strip. Sub-cut twenty-six 1¹/₂" × 7¹/₂" strips.
- Cut two 8¹/₂" × WOF strips. Sub-cut twenty-six 1¹/₂" × 8¹/₂" strips from one strip; sub-cut ten 1¹/₂" × 8¹/₂" and ten 1¹/₂" × 7¹/₂" strips from the other strip.
- Cut two 1¹/₂" × WOF strips. Sub-cut eight 1¹/₂" × 10¹/₂" sashing strips.
- Cut two 10¹/₂" × WOF strips. Sub-cut fifty-two 1¹/₂" × 10¹/₂" sashing strips.
- Cut seven 3" × WOF strips. Sew the strips together end to end and cut two 3" × 65¹/₂" strips and two 3" × 70¹/₂" strips for outer borders.

If you prefer a more scrappy look, cut the cornerstones from assorted holiday leftovers.

From 2¹/₂" Christmas Joy strips:

Note: You will have some leftover strips.

- Select thirty-six strips of your choice. Sub-cut from each strip, one 2¹/₂" square, one 2¹/₂" × 4¹/₂" rectangle, one 2¹/₂" × 5¹/₂" strip, one 2¹/₂" × 7¹/₂" strip, one 2¹/₂" × 8¹/₂" strip and one 2¹/₂" × 10¹/₂" strip. Keep the cut strips together by color as each set makes one block.
- From one strip, sub-cut twenty-five 1¹/₂" cornerstone squares.

From Holiday-CM1284 Red:

- Cut eight 2¹/₂" × WOF strips for binding.

Block Construction

All seam allowances are 1/4" and pieces are sewn right sides together. Note that each block uses a single Christmas Joy fabric.

1. Sew together one 2¹/₂" CM9528 Black square and one 2¹/₂" holiday square (*figure 1*).

Fig. 1



2. Draw a diagonal line on the wrong side of (216) 2¹/₂" CM9528 Black squares. Place a marked square on the corner of the 2¹/₂" × 4¹/₂" holiday rectangle as shown. Sew on the drawn line. Trim 1/4" from the sewn line. Open and press to reveal the corner triangle (*figure 2*).

Fig. 2



3. Sew the step 1 unit to the top of the step 2 unit. Following Figure 3, place a marked square on the top left corner of the sewn unit. Sew on the drawn line. Trim 1/4" from the sewn line. Open and press to reveal the corner triangle.

Fig. 3

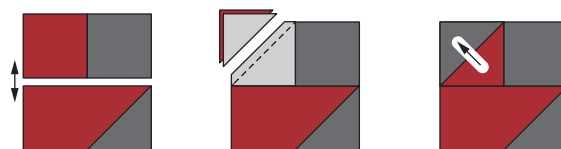

4. Sew a $1\frac{1}{2}'' \times 4\frac{1}{2}''$ CM9528 Black strip to the left of the step 3 unit, followed by a $1\frac{1}{2}'' \times 5\frac{1}{2}''$ CM9528 Black strip to the bottom (*figure 4*).

Fig. 4

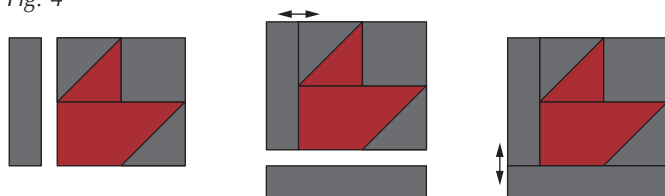

5. Following Figure 5, place a marked square on the left corner of the $2\frac{1}{2}'' \times 5\frac{1}{2}''$ holiday strip. Sew on the drawn line. Trim $\frac{1}{4}''$ from the sewn line. Open and press to reveal the corner triangle. Repeat with another $2\frac{1}{2}''$ CM9528 Black square on the right end of the $2\frac{1}{2}'' \times 7\frac{1}{2}''$ holiday strip.

Fig. 5

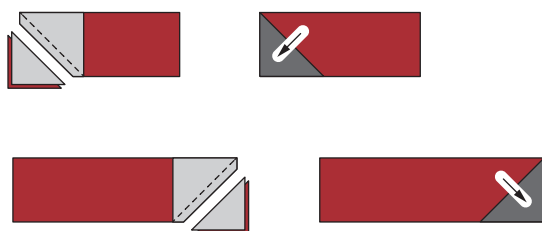

6. Following Figure 6, sew the $2\frac{1}{2}'' \times 5\frac{1}{2}''$ holiday strip to the left of the step 4 unit and the $2\frac{1}{2}'' \times 7\frac{1}{2}''$ holiday strip to the bottom.

Fig. 6

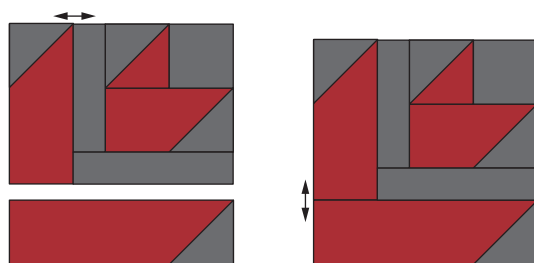

7. Sew a $1\frac{1}{2}'' \times 7\frac{1}{2}''$ CM9528 Black strip to the left of step 6 unit, followed by a $1\frac{1}{2}'' \times 8\frac{1}{2}''$ CM9528 Black strip to the bottom (*figure 7*).

Fig. 7

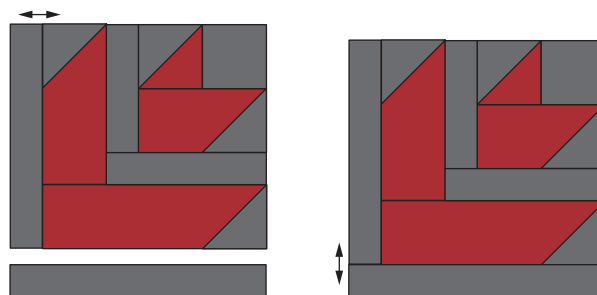

8. Referring back to Figure 5, add a marked $2\frac{1}{2}''$ CM9528 Black square to the left corner of a $2\frac{1}{2}'' \times 8\frac{1}{2}''$ holiday strip and to the right corner of a $2\frac{1}{2}'' \times 10\frac{1}{2}''$ holiday strip. Sew the $2\frac{1}{2}'' \times 8\frac{1}{2}''$ strip to the left side of the step 7 unit and the $2\frac{1}{2}'' \times 10\frac{1}{2}''$ strip to the bottom (*figure 8*).

Fig. 8

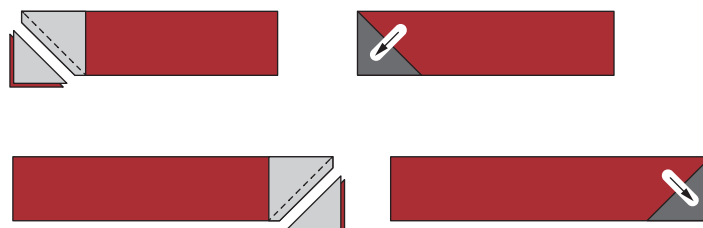

9. Repeat steps 1-8 to make a total of thirty-six assorted holiday blocks.

Fig. 9

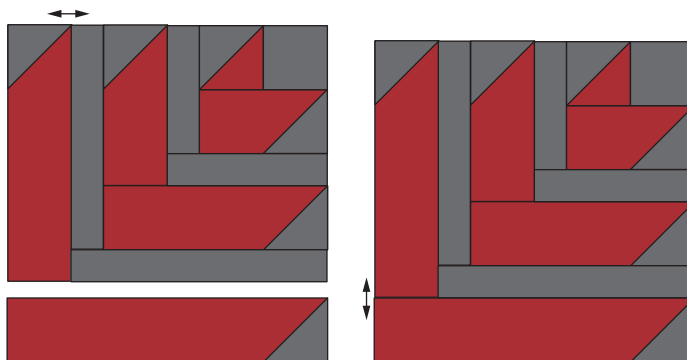

Make 36 assorted.

Quilt Top Assembly

10. Following the quilt image for orientation, lay out six rows of six blocks each. Add a $1\frac{1}{2}'' \times 10\frac{1}{2}''$ CM9528 Black sashing strip between each pieced block. Sew together the blocks and sashing in each row and number the rows for easier assembly.
11. To make the sashing rows, alternately sew together six $1\frac{1}{2}'' \times 10\frac{1}{2}''$ CM9528 Black strips and five $1\frac{1}{2}''$ holiday squares. Make a total of five horizontal sashing rows.
12. Sew the block rows together in order alternately with a sashing row between to complete the quilt top center.
13. Sew a $3'' \times 65\frac{1}{2}''$ CM9528 Black strip to each side of the quilt center followed by a $3'' \times 70\frac{1}{2}''$ CM9528 Black strip to the top and another to the bottom.

Finishing

14. Layer the quilt top, batting, and backing, and quilt as desired.
15. Stitch the binding strips together end to end using diagonal seams. Fold and press the resulting long strip in half lengthwise with wrong sides together. Stitch to the quilt front, matching raw edges and mitering the corners.
16. Fold the binding to the quilt underside and hand-stitch the folded edge to the quilt back.

Wendy Sheppard
www.wendysheppard.net / Instagram: ivory_spring

©2022 Timeless Treasures www.ttfabrics.com
This pattern is for individual home use only. This pattern may not be reproduced for commercial purposes (i.e., may not be sold).

